

HANSON CENTER EAST ADDITION

SPOKANE'S PREMIER COMMERCIAL PARK

SPOKANE VALLEY, WA

BUILD-TO-SUIT & SALE OPPORTUNITY



Nearby Amenities:

- Honey Baked Ham
- Sears
- JC Penny's
- Barnes & Noble
- Best Buy
- Sports Authority
- Staples
- Jo-Ann Fabrics & Crafts
- Sportsman's Warehouse
- Old Navy
- Macy's
- Pier 1
- TJ Maxx
- Black Angus
- IHOP
- Outback Steakhouse
- Krispy Kreme
- Tony Roma's
- Regal Spokane Valley
12 Theater
- Lowe's
- Kohl's
- Wal-Mart
- Ross
- New Hampton Inn Suites
- Garden Inn
- Hooters
- New 250,000 SF Office Building

Professional Office, Light Industrial,
Retail or Medical



- Price: \$8.00—\$12.00
- All off sites complete and utilities stubbed to site.
- Freeway Visibility
- Pad Ready for Construction
- Zoned Mixed Use Center
- Vested traffic is available, See broker for cost & details
- See broker for restrictions affecting Lots 1 - 20

CONTACT

Carl Guenzel
509.755.7543-Direct
carlg@khco.com

Kiemle & Hagood Company
601 W. Main Ave, Ste 400
Spokane, WA 99201
509.838.6541-Phone
509.458.4014-Fax
www.khco.com



Lots 17 - 20



No warranty or representation, expressed or implied, is made by Kiemle & Hagood Company, its agents or its employees as to the accuracy of the information contained herein. All information furnished is from sources deemed reliable and submitted subject to errors, omissions, change of terms and conditions, prior sale, lease or financing, or withdrawal without notice. No one should rely solely on the above information, but instead should conduct their own investigation to independently satisfy themselves

**KIEMLE &
HAGOOD
COMPANY**

SITE PLAN

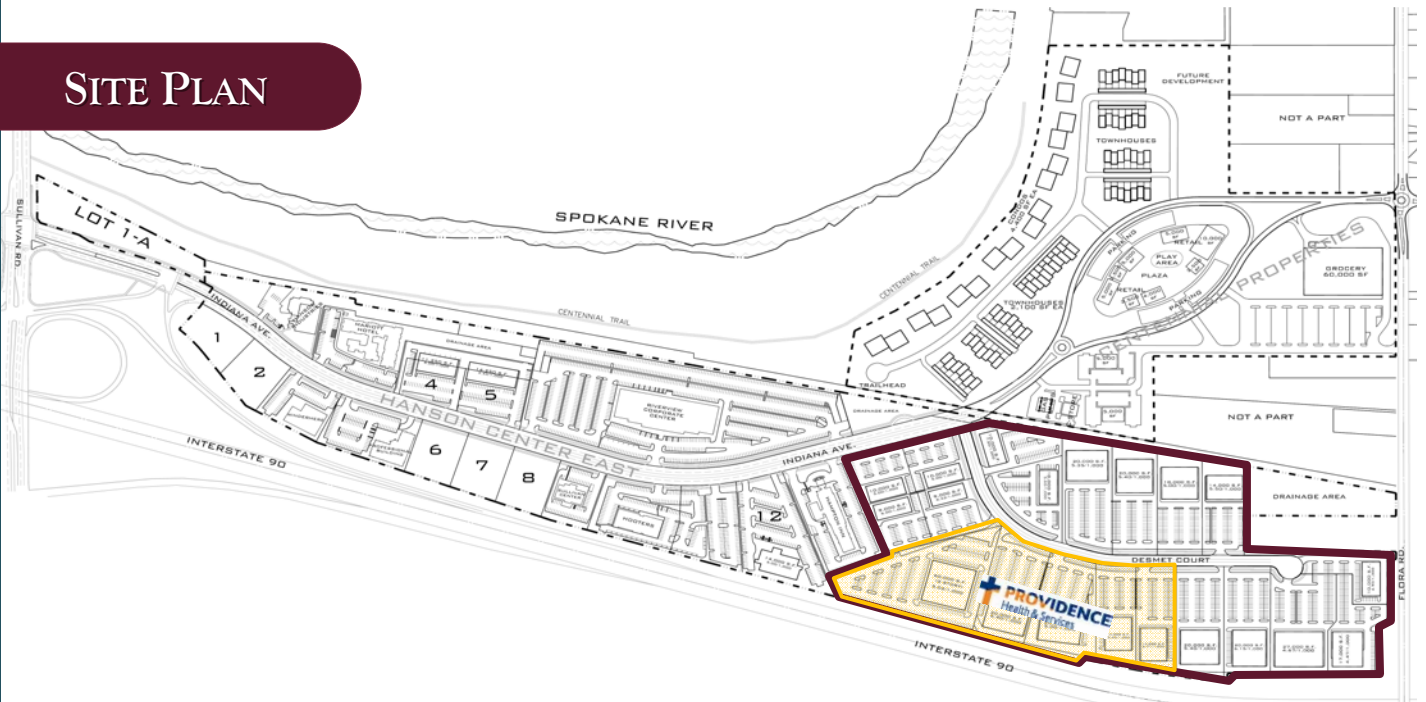

LOT	LAND SF	BDLG SF	ADDRESS
1	57,024	10,000	16609 E. Desmet Court
2	71,116	10,000	16625 E. Desmet Court
3	98,652	20,000	16711 E. Desmet Court
4	79,336	20,000	16727 E. Desmet Court
5	73,489	18,000	16815 E. Desmet Court
6	63,004	14,000	16829 E. Desmet Court
7	53,693	10,000	17010 E. Desmet Court
8	63,811	10,000	17004 E. Desmet Court
9	98,020	27,000	16926 E. Desmet Court
10	80,313	20,000	16916 E. Desmet Court
11	86,845	20,000	16918 E. Desmet Court
12	69,036	14,000	16808 E. Desmet Court
13	64,660	14,000	16720 E. Desmet Court
14	95,683	20,000	16702 E. Desmet Court
15	88,613	20,000	16614 E. Desmet Court
16	165,005	60,000	15528 E. Desmet Court
17	52,333	9,000	16522 E. Desmet Court
18	45,417	9,000	16512 E. Desmet Court
19	49,203	10,000	16424 E. Indiana Avenue
20	49,137	10,000	16506 E. Indiana Avenue

Providence Medical Center Lots 12 - 16

09 Demographics	1 Mile	5 Mile	10 Mile	15 Mile
09 Est Population	4,823	93,315	233,963	439,918
14 Proj Population	5,537	103,904	260,863	485,589
Proj Annual Growth 09-14	3.0%	2.3%	2.3%	2.1%
09 Average HHI	\$54,787	\$59,680	\$61,238	\$61,511
09 Median HHI	\$44,635	\$51,296	\$50,624	\$50,346

Traffic Counts (ADT)

Sullivan & Indiana	28,300
From South on Evergreen	12,542
From West on Indiana	8,214
From East on Indiana	12,668

No warranty or representation, expressed or implied, is made by Kiemle & Hagood Company, its agents or its employees as to the accuracy of the information contained herein. All information furnished is from sources deemed reliable and submitted subject to errors, omissions, change of terms and conditions, prior sale, lease or financing, or withdrawal without notice. No one should rely solely on the above information, but instead should conduct their own investigation to independently satisfy themselves